



Photo Credit: Joah Bussert

VISION:

After the tornado, multitudes of people started coming to town to help with the recovery and to learn about the Green Initiative. Many visitors expressed an interest in viewing the “green” homes that were being built, and the Chain of Eco-Homes concept was born. Because we couldn’t ask residents to host a continual parade of visitors, it made sense to build tourable eco-homes where people could spend the night. The idea behind the project is to construct a series of houses, each with a different sustainable building envelope and each featuring both cutting-edge and “retro” technologies and practices that save money and wisely use resources. The goal is to create a “living science museum” of the latest in eco-friendly residential design.

As the first of GreenTown’s Chain of Eco-Homes, the Silo Eco-Home showcases durable building construction, energy efficient features, and green materials & products. It houses a bed & breakfast suite, GreenTown’s administrative offices and Greensburg’s Green Visitors Center. Eco-tourists can schedule a GreenTour of Greensburg or rent our guest suite to experience green living first hand.

For more information about Greensburg GreenTown’s projects & how you can contribute, please visit our website or contact us at: info@greensburggreentown.org

To schedule a GreenTour of Greensburg, or a night in the Silo Eco-Home please call or e-mail:

620-723-2790

reservations@greensburggreentown.org

For after-hours reservations, please call 620-723-1108



Silo Eco-Home
620-723-2790
402 S. Sycamore St.
Greensburg, Kansas 67054

www.greensburggreentown.org

Special *Thanks* to our Eco-Home Donors!

Platinum Level:



Gold Level:



Silver Level:



Bronze Level:



Additional Donors

2Acre Tile | American Honda Motors | Bethel Sewing Ladies | Justin Brouillette
The Carpenter Shoppe | cfm Distributors | Circle C Farms | Cornerstone Interiors
Decorative Concrete Supply | Ed Schoenberg | Excel Industries | Ki & Kim Gamble
Greensburg State Bank | Joan Hayes | HTNB Corporation | Integreen | Kansas Gas Service
Keystone Construction | LED Lighting Solutions | Mark & Nancy Magliery | NREL
OneCleanWorld Foundation | Overhead Door of Dodge City | PF Waterworks | Rocky Preble
Randy Rinker | Kenneth & Phyllis Schmidt Family | South Central Community Foundation | Spin-X
Stallard Technologies | Sunflower Electric Supply | Sunflower RC & D | Tippy Pix/NKP Media

Silo Eco-Home

by Armour Homes

First in the Chain of Eco-Homes

On May 5th, 2007, the day after the tornado, Greensburg residents looked north and saw the grain elevator standing tall. Even though the EF5 tornado had flattened nearly everything else in town, the elevator remained unscathed. To honor the durability of this structure GreenTown is proud to showcase The Silo Eco-Home as the first in the Chain of Eco-Homes.

This demonstration home was built using the same method and materials typically used to construct a traditional grain elevator or silo. Six-inch thick concrete walls can withstand the high winds of a tornado while a myriad of green features in the home showcase both established and cutting-edge techniques for sustainable living.

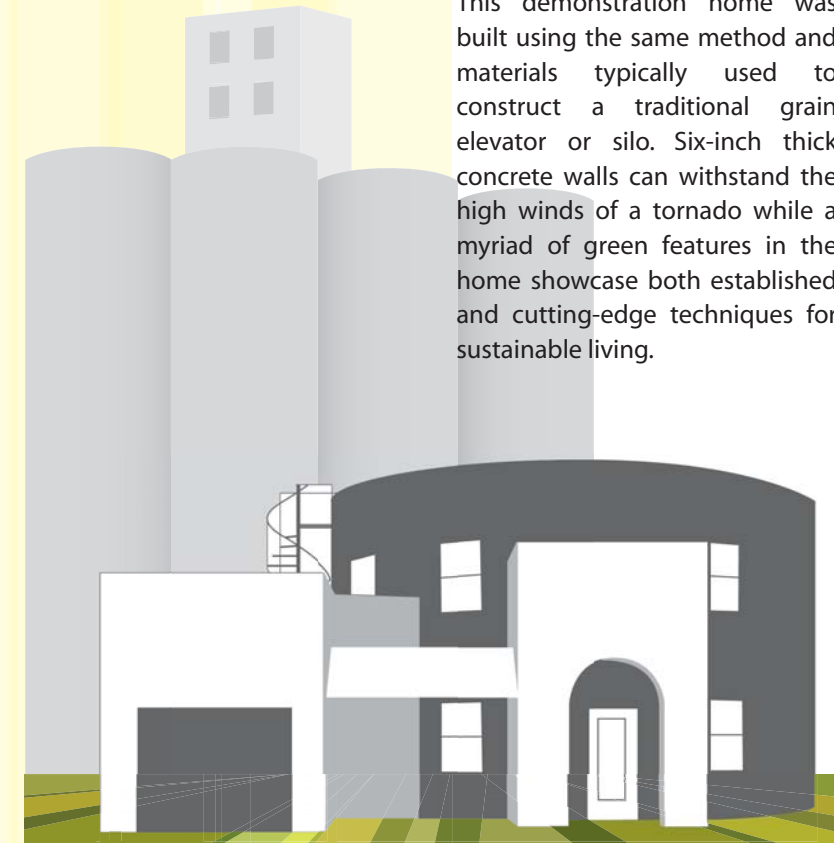

The Chain of Eco-Homes

EXTERIOR green FEATURES:

- A Driveway**
 - Permeable Pavers by *Permapave*
- B Landscape**
 - Pre/Post-storm Trees
- C Natural Gas Fuelmaker**
- D Tornado Shelter**
 - Indoor/Outdoor Shelter by *New Day Tornado Shelters*
- E Photovoltaic (PV) Panel**
 - 2 kw Grid Tied System by *Bauer Power*
- F Household Compost**
- G Double Skin Wall**
- H All-Electric Riding Lawnmower**
 - The Hustler ZEON by *Excel Industries Inc*
- I Rooftop Garden**
 - Extensive Green Roof System by *Diamond Roofing*



2nd Floor Plan

GENERAL green FEATURES:

- Site Considerations**
 - Silo form reduces wind drag on the structure
 - Windows are oriented to optimize natural lighting & passive heating
 - Small 1,000 SF footprint reduces site impact
- Building Envelope**
 - Stucco by *Dryvit*, 6" Cast Concrete, & 4" Rigid EPS Insulation compose a durable and efficient exterior wall system with an R-value of 25+
 - Highly-insulated Windows by *Serious Materials* have U-values of .19 & .24
 - Concrete Roof provides an R-value of 40+
- Materials**
 - Color treated concrete flooring on 1st floor is eco-friendly & durable reducing the need for additional floor coverings, product by *SkimStone*
 - Recycled Styrofoam Trim Board by *Timbron*
- Lighting**
 - LED lighting by *LED Lighting Solutions*
 - Additional Compact Fluorescent Lighting (CFL)
- Indoor Air Quality**
 - No VOC Interior Paint by *Andover Paint Center*
 - Ceiling fans by *Accent Lighting* promote air circulation
 - Green Cleaning Products, no harsh chemicals
 - Low VOC Caulk Sealants by *DAP*
- Energy Monitoring**
 - Continuous monitoring of PV panel and general house energy usage

INTERIOR green FEATURES:

- 1 Green Visitors Center & Gift Shop**
 - Green Product Information & Library
 - Energy Efficient LED TV by *Vizio*
 - Organic Cotton T-shirts
 - Eco-friendly Merchandise
- 2 Kitchen**
 - Reclaimed Cabinets
 - Recycled Glass Countertops by *EnviroGLAS*
 - Energy Efficient Appliances by *Sears Kenmore*
 - Recycling Center
 - Tile with Recycled Content by *Daltile*
- 3 Guest Suite by Raymond C. and Anna T. Johnson Foundation**
 - Organic Latex Bed by *Savvy Rest*
 - All-Natural Bedding
 - Natural Bath Products by *EO*
 - Quilt by *Bethel Sewing Ladies*
 - Energy Efficient LED TV by *Vizio*
 - Low-flow Showerhead by *Evolve*
 - Dual-flush Toilet by *Caroma*
 - Tile with Recycled Content by *Daltile*
- 4 Restroom**
 - Dual-flush Grey Water Toilet by *Caroma*
 - Recycled Glass Countertop by *EnviroGLAS*
 - Reclaimed Vanity Cabinet
- 5 Utility Room**
 - High Efficiency Washer & Dryer by *Sears Kenmore Elite*
 - Centrifuge Pre-Dryer by *Spin-X*
- 6 Garage**
 - Recycled Wood Fiber Garage Door by *Overhead Door*
 - SMA Power Inverter for PV Panel by *Bauer Power*
 - Instantaneous Hot Water Heater by *Noritz*
 - Whole-House Water Purification System with Water Softener by *Sears*
- 7 Office**
 - Energy Efficient LED TV & Sound System by *Vizio*
 - Stranded Bamboo Flooring by *Warner Bamboo*
 - Iron Railings by *TallGrass Forge*
 - Aeron Chairs by *Herman Miller*
 - Office Furniture by Hon via *Office Depot*
 - HP TouchSmart Computers via *Office Depot*
 - Energy Efficient Blinds by *Hunter Douglas*
 - Ventilation Cupola
- 8 Restroom**
 - Adapted Antique Dresser Vanity, with Recycled Glass Countertop by *EnviroGLAS*
 - Low-flow Showerhead by *Evolve*
 - Dual-flush Toilet by *Caroma*
 - Tile with Recycled Content by *Daltile*
- 9 Mechanical Room**
 - York High Efficiency Split System Heat Pump by *Johnson Controls*
- 10 Roof Deck by The Heft Families**
 - Recycled Low Maintenance Decking by *Trex*

Denotes Donor Company

SYCAMORE ST

IOWA AVE

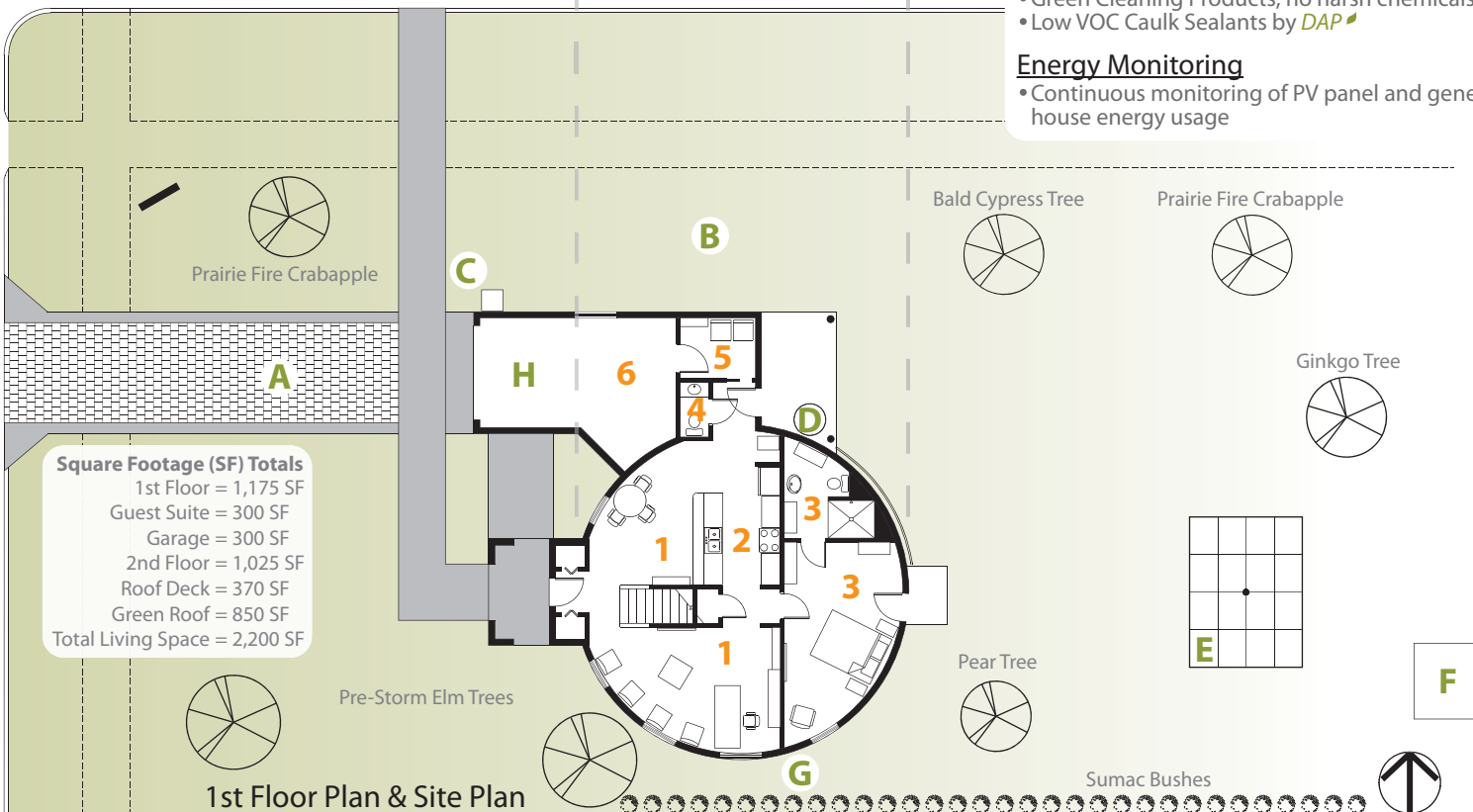

Square Footage (SF) Totals
 1st Floor = 1,175 SF
 Guest Suite = 300 SF
 Garage = 300 SF
 2nd Floor = 1,025 SF
 Roof Deck = 370 SF
 Green Roof = 850 SF
 Total Living Space = 2,200 SF

Silo Eco-Home